

## 2007 Hummer H3

### 2007 BRAKES Antilock Brake System - H3

9. Install the brake master cylinder and power brake booster assembly. Refer to **Brake Master Cylinder with Power Brake Booster and Chassis Control Module Replacement (LHD)** or **Brake Master Cylinder with Power Brake Booster and Chassis Control Module Replacement (RHD)**.
10. Bleed the hydraulic system. Refer to **Hydraulic Brake System Bleeding (Manual)** or **Hydraulic Brake System Bleeding (Pressure)**.
11. Refer to **Control Module References** for programming and setup information.

#### FRONT WHEEL SPEED SENSOR REPLACEMENT

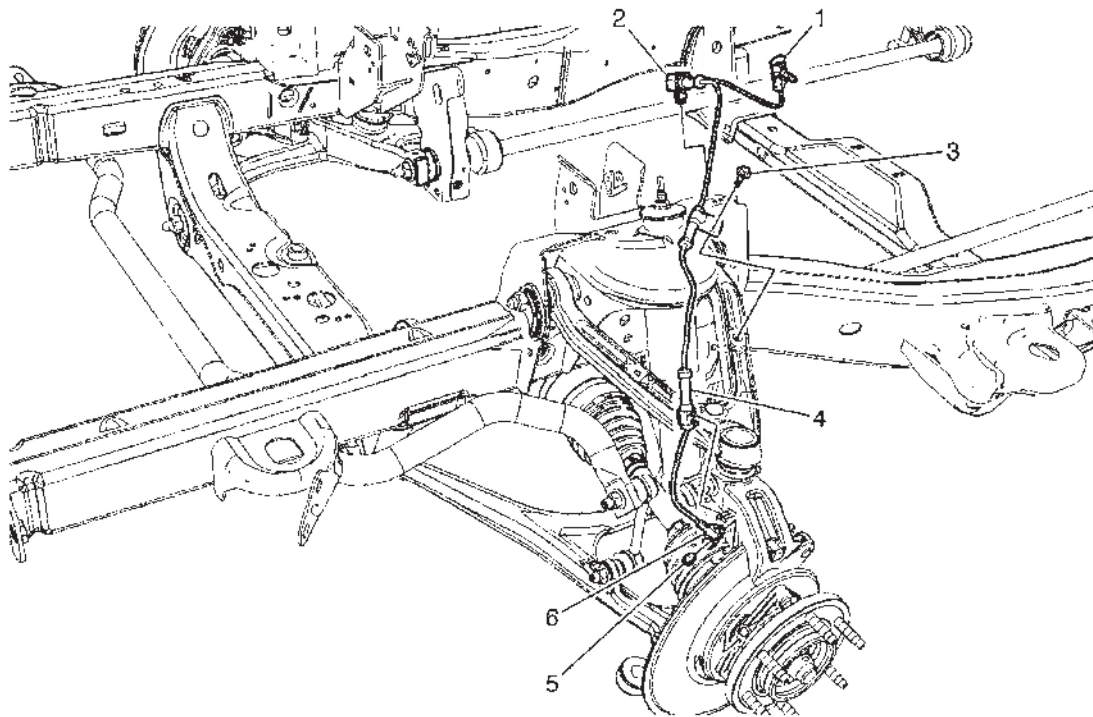

**Fig. 44: Replacing Front Wheel Speed Sensor**  
Courtesy of GENERAL MOTORS CORP.

#### Front Wheel Speed Sensor Replacement

Callout	Component Name
<b>Preliminary Procedures</b>	
1.	Raise and support the vehicle. Refer to <b><u>Lifting and Jacking the Vehicle</u></b> .
2.	Remove the tire and wheel. Refer to <b><u>Tire and Wheel Removal and Installation</u></b> .
3.	Remove the front disc brake rotor. Refer to <b><u>Front Brake Rotor Replacement</u></b> .

## 2007 Hummer H3

### 2007 BRAKES Antilock Brake System - H3

1	Wheel Speed Sensor Electrical Connector <b>Procedure:</b> Disconnect the electrical connector and release the clip from the vehicle body.
2	Wheel Speed Sensor Wiring Harness Retaining Clip
3	Wheel Speed Sensor Harness Clip Bolt (if equipped)  <b>NOTE:</b> <b>Refer to <u>Fastener Notice</u> .</b>  <b>Tip:</b> If equipped with a wheel speed sensor wire harness clip, release the clip from the upper control arm.  <b>Tighten:</b> 9 N.m (80 lb in)
4	Wheel Speed Sensor Wiring Harness Retaining Clip
5	Wheel Speed Sensor Mounting Bolt <b>Tighten:</b> 18 N.m (13 lb ft)
6	Wheel Speed Sensor

### REAR WHEEL SPEED SENSOR REPLACEMENT

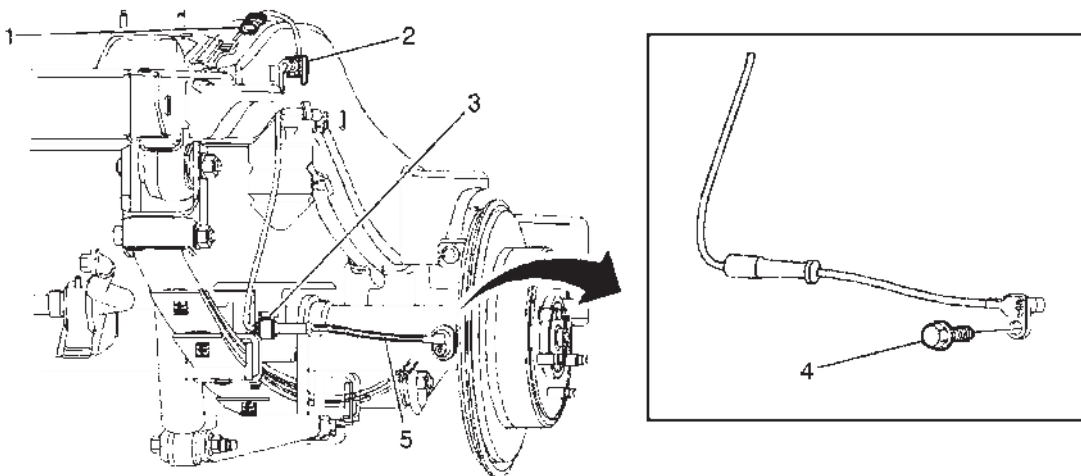

**Fig. 45: Wheel Speed Sensor Replacement - Rear**  
**Courtesy of GENERAL MOTORS CORP.**

**Rear Wheel Speed Sensor Replacement**

## 2007 Hummer H3

### 2007 BRAKES Antilock Brake System - H3

Callout	Component Name
<b>NOTE:</b> Refer to <u>Fastener Notice</u> .	
<b>Fastener Tightening Specifications:</b> Refer to <u>Fastener Tightening Specifications</u> . <b>Preliminary Procedure:</b> Raise the vehicle. Refer to <u>Lifting and Jacking the Vehicle</u> .	
1	Connector, ABS Electrical
2	Clip, ABS Wiring Harness Frame Retaining
3	Clip, ABS Wiring Harness Axle Housing Retaining
4	Bolt, Wheel Speed Sensor Mounting (Qty: 2) <b>Tighten:</b> 18 N.m (13 lb ft)
5	Sensor, Wheel Speed

## REAR WHEEL SPEED SENSOR RING REPLACEMENT

### Tools Required

- **J 8092** Driver Handle
- **J 21128** Axle Pinion Oil Seal Installer
- **J 23690** Bearing Installer
- **J 2619-01** Slide Hammer
- **J 45857** Tone Wheel and/or Bearing Remover
- **J 45860** Tone Ring Installer

### Removal Procedure

1. Raise the vehicle. Refer to Lifting and Jacking the Vehicle .
2. Remove the tire and wheel assembly. Refer to Tire and Wheel Removal and Installation .
3. Remove the rear wheel speed sensor. Refer to Rear Wheel Speed Sensor Replacement.
4. Remove the rear axle housing cover. Refer to Rear Axle Housing Cover and Gasket Replacement .
5. Remove the axle shaft. Refer to Rear Axle Shaft Replacement .